

Reader **vG-Reader 2**
- remote reader for the apartment



vG-BLreader2

Remote reader for the apartment vG-BLreader 2

The main task of the vG-BLreader 2 is to supervise and provide access to the selected object to people from any place and at any time.

The reader allows you to secure external doors with the use of an electric strike or electromagnetic lock. Ideally suited to apartments, flats and any premises for rent, to which we do not have daily access and we want to have control over them. The operation is intuitive and very easy to learn. The administrator gives the selected person the right to open by generating a code and send it via SMS. The device we offer is easy to install and fits virtually any door.



The reader is managed in the following ways: through a code or the free TTlock, TThotel or TTrenting application. Easy opening of the door after entering the code after which the time is counted, or using an application that connects the user with the systems via Bluetooth on his phone. In addition, the reader can be played using a Mifare 13.56MHz card, Bluetooth or a fingerprint (on request).

TO CONFIGURE THE READER, IT IS NECESSARY TO EXECUTE **4 SIMPLE STEPS:**

1- We download the **free TTlock application** available on:

Android

and

iOS



YOU CAN USE TTLOCK ALSO WITH A PC

2- **Log in** for the first time and set up an account ...

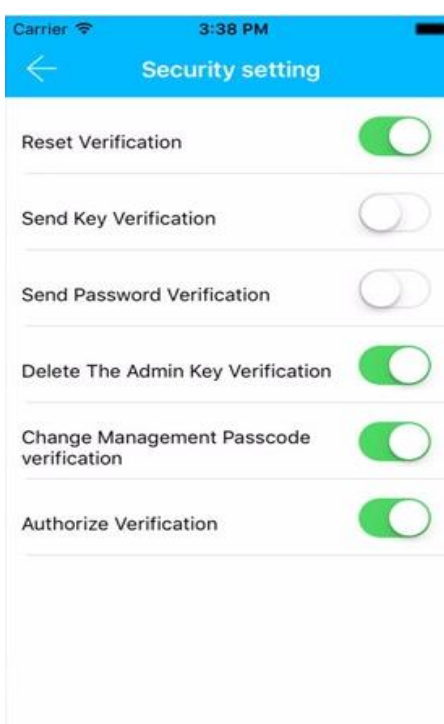
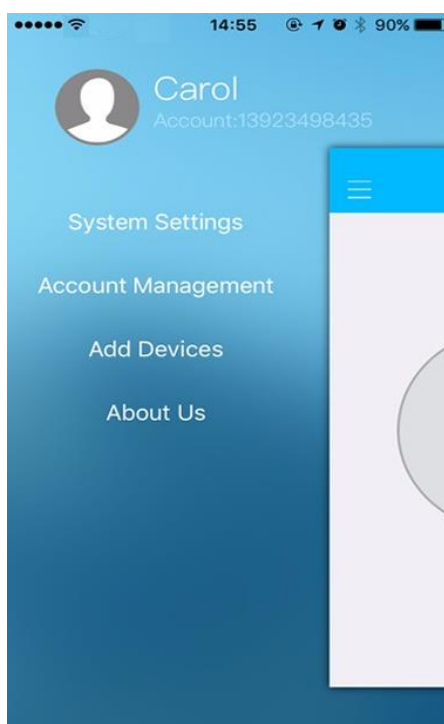
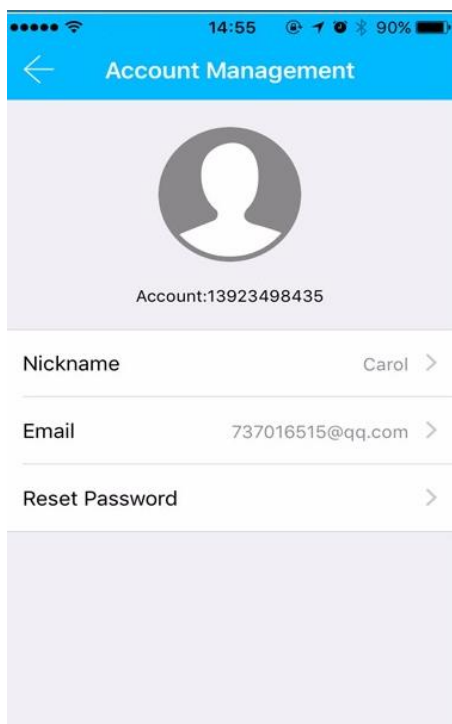

3- We add readers one by one, **the quantity is unlimited ...**

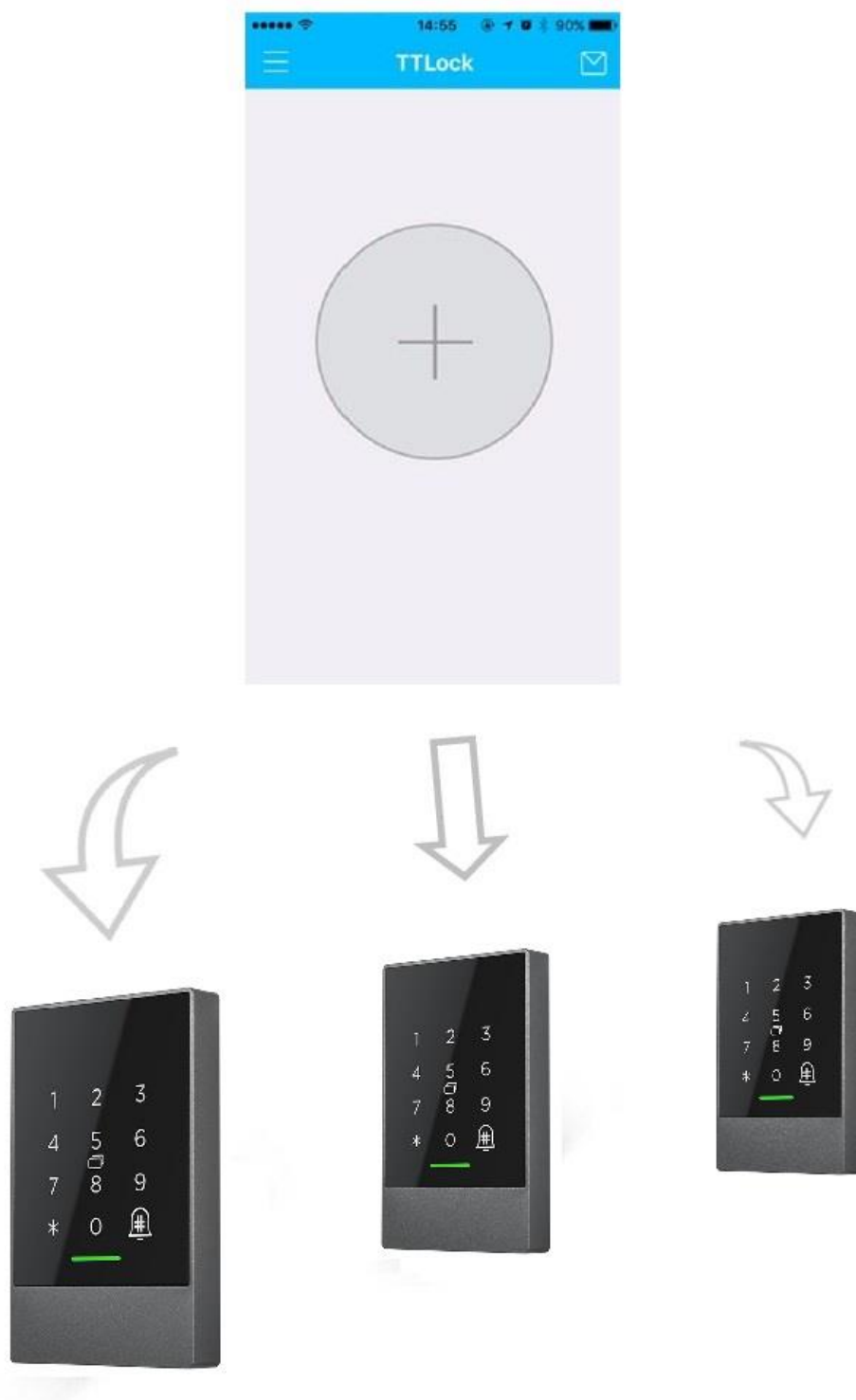

4- We set the **guest's stay time** for a given location, then select the opening method and send the configuration to the user:



Access via Bluetooth



We choose the reader, set the duration of stay and send access via email or mms. The user turns on bluetooth and brings the phone closer to the reader and opens it for 7 seconds. We have access to the event viewer, we can remotely block access and remove or add a new user.

← eKey

Permanent Timed

Reciever
+86 Enter reciever's account

Description
Description

Active Time 2017-01-06 11:09

Expire Time 2017-01-06 12:09

Cancel Curr...t time OK

2017 Y 01M 06D 11 H 09M
2018 02 07 12 10
2019 03 08 13 11
2020 04 09 14 12

Access via PIN Code



We select the reader, set the guest's stay time From - To, the application generates a code based on the algorithm. We send the generated code by text message or email to the user. The user enters the code on the keyboard. Reader opens for 7 seconds. After the specified date has elapsed, the reader stops responding to the code entered.

← Passcode

Permanent Timed Cyclic One-time

Active Time 2017-05-05 11:00

Expire Time 2017-05-05 11:00

☐ Delete previous passcodes

Generate

ATTENTION:
1.If 'Delete previous passcodes' box is checked, all passcodes on the lock will be invalid when the new passcode is used for the first time.
2.If the passcode is not used within 24 hours from the start time, it is invalid. Please request a new passcode.

Send by WeChat

Send by Msg.

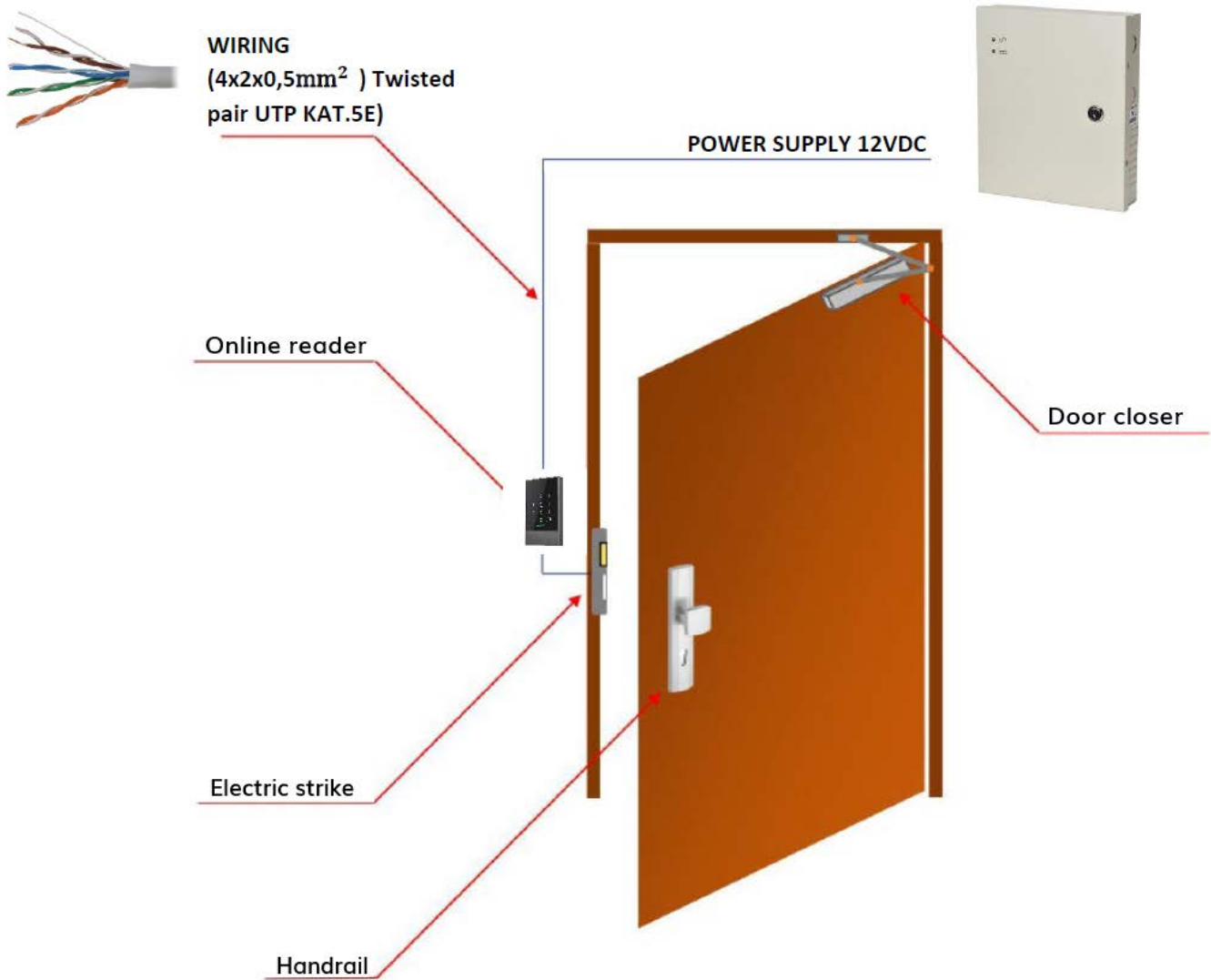

- Dimensions: 79 x 125 x 15.5 mm,
- Opening by code, Mifare 13.56MHz card, TTlock application (Bluetooth), and fingerprint (optional)
- Material: aluminum, tempered glass,
- Reading range: 0-10 mm,
- Reading time: ~ 1.5s
- Internal memory for 20,000 users
- IP66 protection,
- External 12 V DC power supply,
- Relay for controlling the actuator (500mA),
- Working temperature: -20 - + 70oC,
- Communication: Bluetooth 4.1



Connection diagram

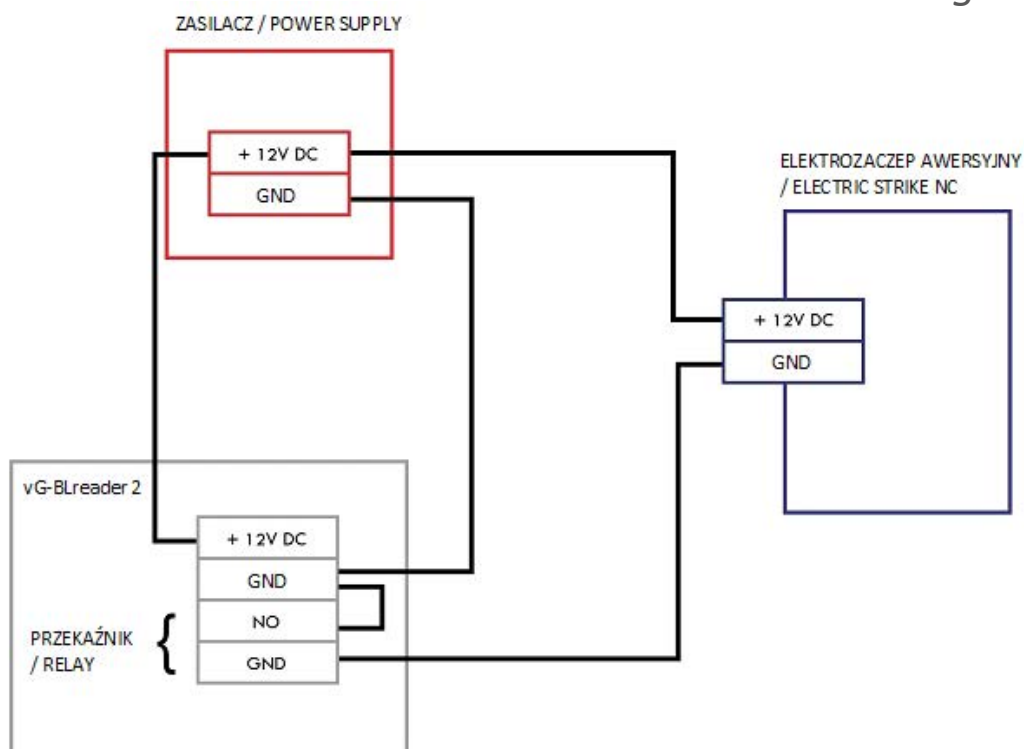

Use

- THE READER IS RESISTANT TO WEATHER CONDITIONS, IT IS USED FOR INTERNAL AND EXTERNAL USE
- CLEANING WITH A SLIGHTLY HUMID CLOTH, OR WITH A LIQUID FOR WINDOWS
- THE KEYBOARD MUST NOT BE EXPOSED TO MECHANICAL DAMAGES
- WHEN THE READER IS STRONGLY EXPOSED TO ADVERSE ATMOSPHERIC CONDITIONS, A SPECIAL PROTECTIVE CANOP MUST BE APPLIED
- USE 12V POWER SUPPLIES WITH AMPERAGE EQUAL TO OR GREATER THAN 500mA