



# miniCam cabinet lock

## Instruction manual



-  Low voltage indicator
-  Unlocking indicator light

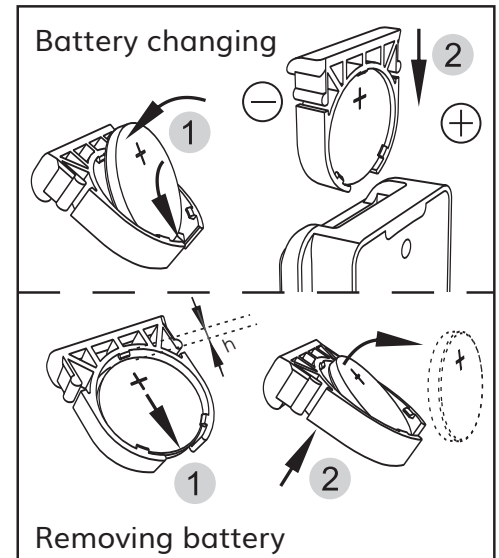
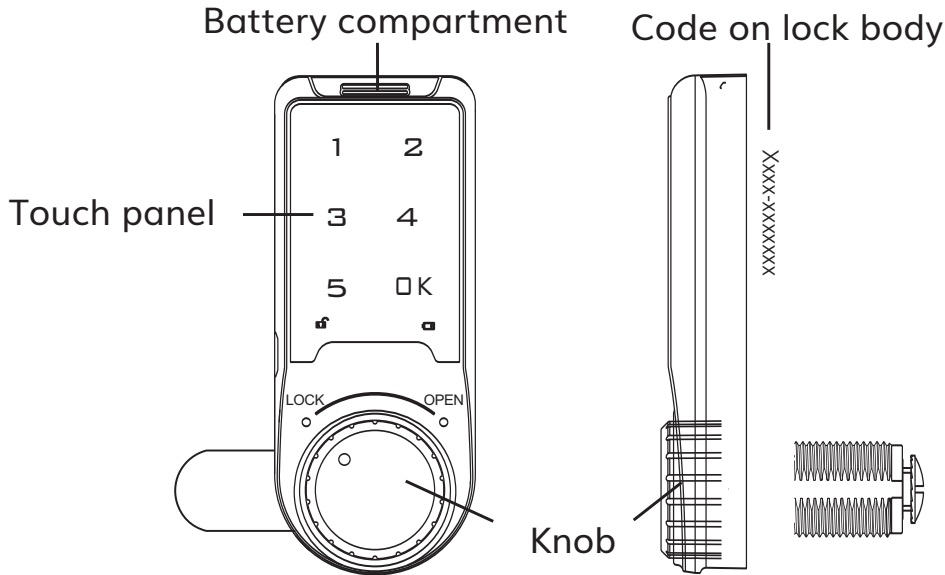

# Operating

## ■ Unlocking and locking of the lock

### Unlocking

1. Set your password "1234", or enter the user password "4321 + OK"
2. The castle will make a long, prolonged "dee" sound
3. When the green indicator  is visible, turn the knob 90 degrees within 3 seconds to unlock the lock.

- \* If the code is incorrect, the lock will beep three short beeps.
- \* When the lock displays this symbol , it means low battery.
- \* When a management password was used to open, the user's password will be reset to the default 1234

## ■ Unlocking and locking of the lock

### 1 - Changing password

1. Enter the current password "1234 + OK", or enter the factory management password "4321 + OK". The lock will then make a long "dii" sound and the unlock indicator  will flash rapidly.

2. Hold OK for at least 2 seconds, then when the unlocking indicator  starts blinking, enter the new password, press OK, and when you hear a long "dii" beep, it means that the password has been changed

\*Password can contain from 4 to 15 digits. **The user password cannot be the same as the management password.**

### 2 - Launching public mode, setting a temporary password

#### Public mode

1. Enter the current management password and press OK, then the lock will make a long beep "dii" and the unlocking indicator  is on

2. Hold down OK for at least 2 seconds and while the unlocking indicator  blinks, press OK.

3. Enter "4 4" and press OK, when you hear a long "dii" beep, it means that public mode has been turned on.

#### Setting a one-time password in public mode



1. Press OK. Unlocking indicator  will blink

2. Enter a new 4-15 digit password



3. Press OK, and when the lock makes a long "dii" beep, it means that the one-time password has been entered correctly.

\*The flashing unlocking indicator  every 3 seconds means that a one-time password has already been assigned to the lock

### 3 - Turning off the public mode

1. Enter the current management password and press OK, then the lock will make a long beep "dii" and the unlocking indicator  will be on
2. Hold OK for at least 2 seconds, and when the unlocking indicator  starts blinking, press OK again.
3. Enter "4 3", then press OK, when you hear a long "dii" beep, it means that public mode has been turned off

### 4 - Turning on/off fake PIN code function

1. Enter the current management password and press OK, then the lock makes a long beep "dii" and the unlocking indicator  is on.
2. Hold OK for at least 2 seconds, and when unlocking indicator  starts flashing, press OK again.
3. Enter "4 2", then press OK, and when you hear a long "dii" beep, it means that the fake PIN code function has been turned on.
4. Enter "4 1", then press OK, and when you hear a long "dii" beep, it means that the fake PIN code function has been disabled.



\*While the Fake PIN function is enabled, you can enter additional numbers before and after your real PIN and the lock will read the matching password itself. The maximum number of digits is 16.

## ■ Functions

### 1 - Decoding

1. When the password has been forgotten, the decoding number can be obtained by providing the distributor with the lock number (located on the casing) to be decoded. The password will be changed back to the original management password "4321" and the user password "1234".
2. Thanks to the fake PIN code function, you can enter additional digits before and after your real PIN code, and the lock will read the matching password itself. The maximum number of digits is 16.
3. The auto-alarm will be activated after entering a wrong code 4 times in a row, then the lock will be inactive for 60 seconds.
4. Low battery message (the lock will display a low battery indicator .
5. The last entered password will be remembered after the battery replacement.

## ■ Solving most common issues

Issue	Main cause	Solution
When entering a password, two "dii dii" sounds are heard and the indicators   flash twice	Too low voltage	Battery change
When entering a password, a "dii" sound is heard while the unlocking indicator  is on but the lock does not open	Knob is not in the right position	Turning on the knob into the right position
The touch panel is silent, the lock opens	Buzzer is broken	Changing the buzzer

## ■ Drilling and montage

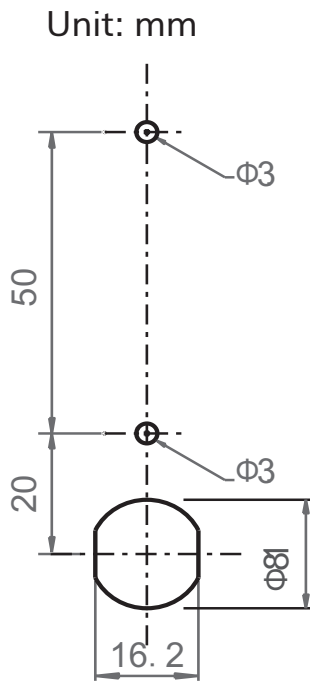

Right thickness:

- steel: 0,5~1,5mm
- wood: 16~20mm

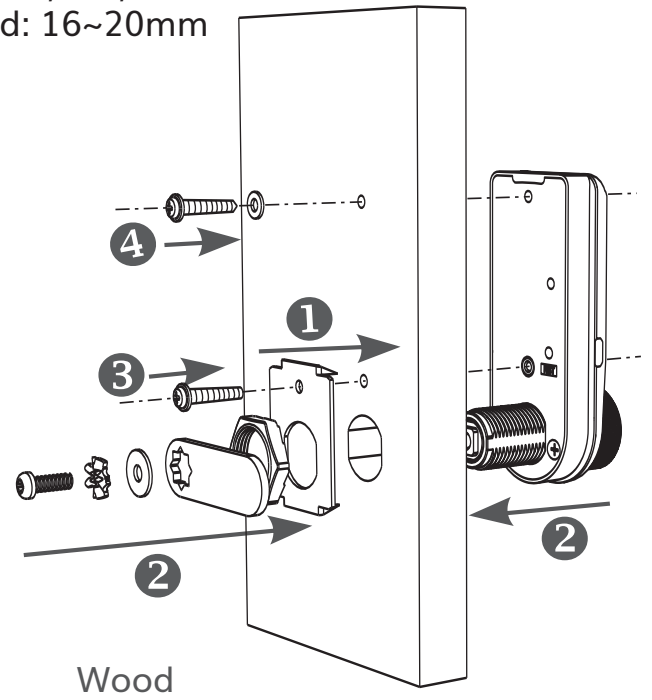



*ul. Jana III Sobieskiego 80B  
62-030 Luboń, Polska*

*tel. 61 307 22 35 email:*

*biuro@wano.pl www.wano.pl*

