

Low gate BF- DZ402



SAFETY

DESIGN

PRICE

DESCRIPTION

- Bramofurta is characterized by a higher level of security than a turnstile.
- Made of brushed stainless steel.
- Ability to operate in both indoor and outdoor environments.
- It has a relay signal that can be integrated with external access control systems (e.g., RFID reader, biometric reader, etc.).
- Compatibility with external devices such as: display, reader, facial recognition, entry/exit button, card collector, coin acceptor, barcode reader.
- The passage will be opened automatically in case of power loss.
- Only one person will pass in one cycle.

MAIN FEATURES

- Long lifespan, high reliability, fast operation.
Quiet operation.
- Ability to operate in one-way as well as two-way.
- The gate will automatically block if a pedestrian does not pass through the gate within 5 seconds (can be adjusted).
- The passage will open automatically in case of power loss.
- The LED indicator (red x means no access; green → means access has been granted).
- The wiring is located inside the housing.
- The end of the arm is fitted with a round cover made of stainless steel.



We offer not only revolving gates

We offer complete access control solutions



SPECIFICATION

Model	BF-DZ402
Type	Low gate
Communication	Potential-free contact, relay signal, RS485
Housing execution	Brushed stainless steel
Dimensions	2200*1449*1100mm
Net weight	200 kg
Width of passage	2 * 565.5mm
Direction of operation	One-way / Two-way
Power supply	AC220V/110V, 50/60Hz
Voltage	24V DC
Power consumption	40W
Operating temperature	-15 °C - 60 °C
Working humidity	0 ~ 95%
Working environment	Internal / External
Throughput	35-40 people per minute
Emergency mode operation	Automatic opening of the passage in case of power loss
Integration capability	Any access control system

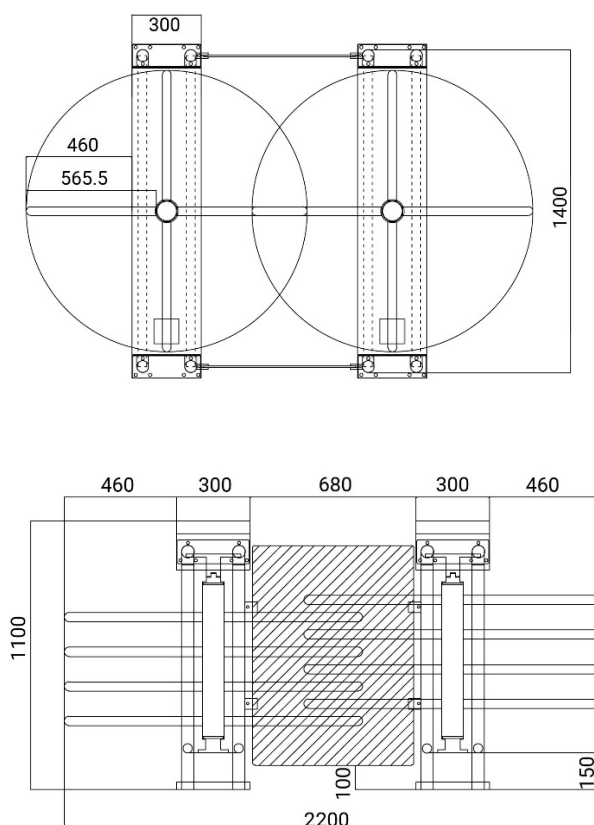

Low barrier gate BF-DZ402



Bramofurta niska BF-DZ402 is perfect for installation in both outdoor and indoor environments.

It connects perfectly with the pedestrian gate BP-6003.



Pedestrian gate BP-6003B