



High gate BW-412

SECURITY

DESIGN

PRICE

DESCRIPTION

- The high gate BW-412 provides high-quality access control.
- It is made of brushed stainless steel.
- It is suitable for installation in both indoor and outdoor settings.
- It has a relay signal that can be integrated with external access control systems (e.g., RFID reader, biometric reader, etc.).
- Compatibility with external devices such as: display, reader, facial recognition, entry/exit button, card collector, coin acceptor, barcode reader.
- Automatic opening of the passage in case of power loss.
- Only one person will pass in one cycle.

MAIN FEATURES

- Long lifespan, high reliability, fast operation.
- If necessary, the gateway can operate in manual mode.
- Quiet operation.
- Single directional or Bi-directional is selectable.
- The gate will automatically lock if the pedestrian does not pass through the gate within 5 seconds (can be adjusted).
- LED indicator (red "x" means no access; green "→" means access has been granted).
- Cabling can be routed in the housing.
- Easy installation.



We offer not only turnstiles

We offer complete control solutions



SPECIFICATION

Model	BW-412
Type	High gate
Communication	Potential-free contact, relay signal, RS485
Housing execution	Stainless steel 304
Dimensions	2200*1400*2180mm
Net weight	320 kg
Width of passage	2 * 650mm
Direction of work	One-way / Two-way
Power supply	AC220V/110V, 50/60Hz
Voltage	24V DC
Power consumption	40W
Operating temperature	-15 °C - 60 °C
Working humidity	0 ~ 95%
Working environment	Internal / External
Throughput	35-40 people per minute
Emergency mode operation	Automatic opening of the passage in case of power loss
Integration capability	Any access control system

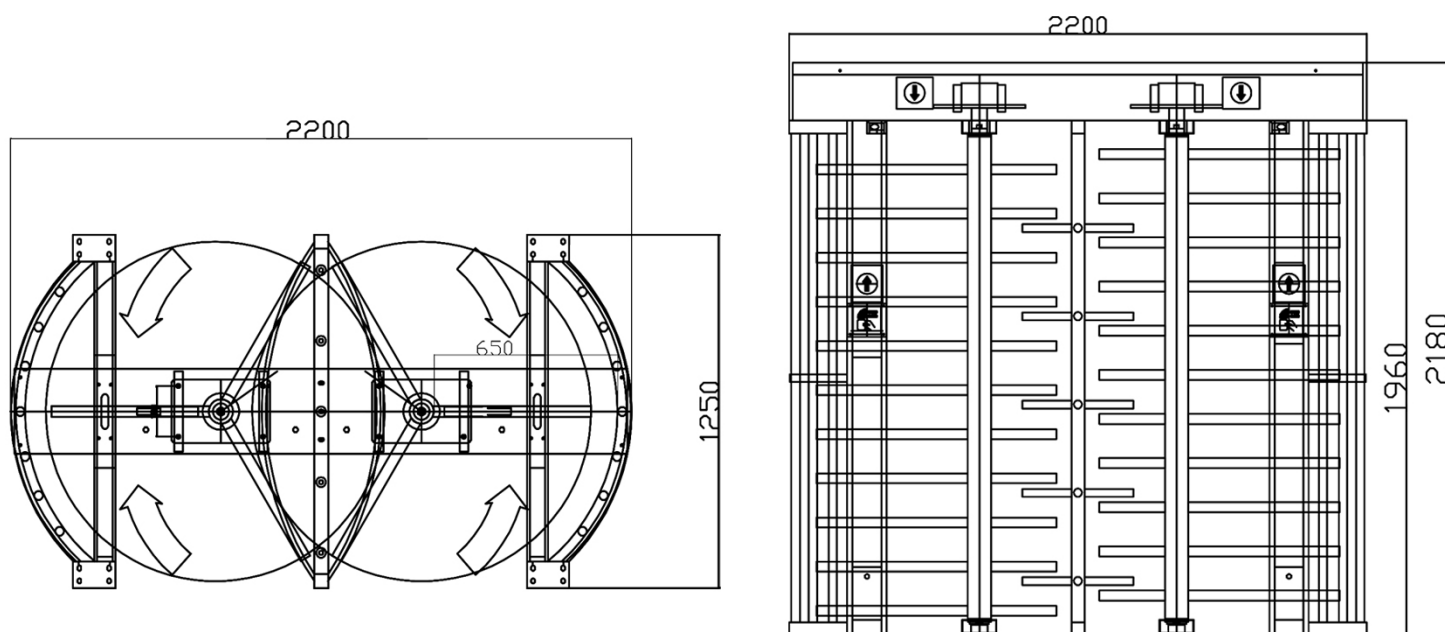

Pedestrian gate BP-6004

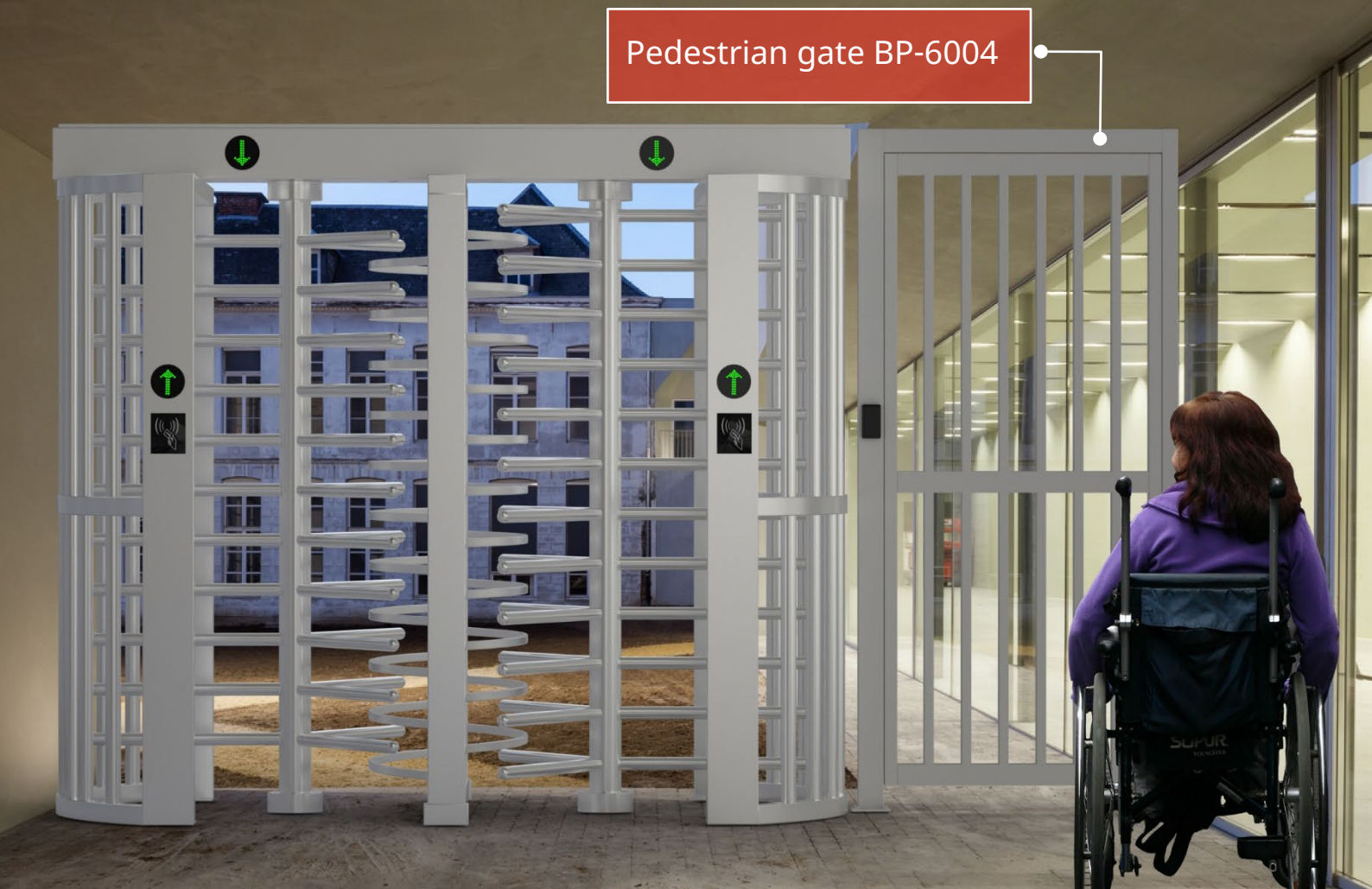

The high gate BW-412 is a two-passageway gate made of stainless steel. It is suitable for installation in both indoor and outdoor environments. It can work with other devices such as the pedestrian gate BP-6004.



Pedestrian gate BP-6004