

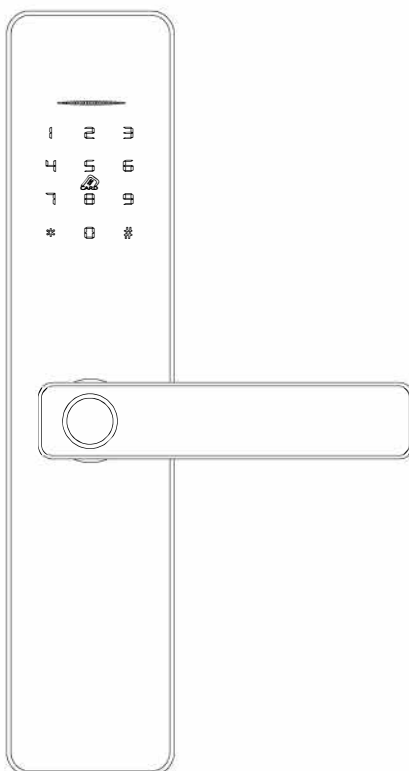

Smart lock manual

Suitable for indoor doors, wooden doors, homestays and offices



Installation guide of double latches mortise

1. Accessory

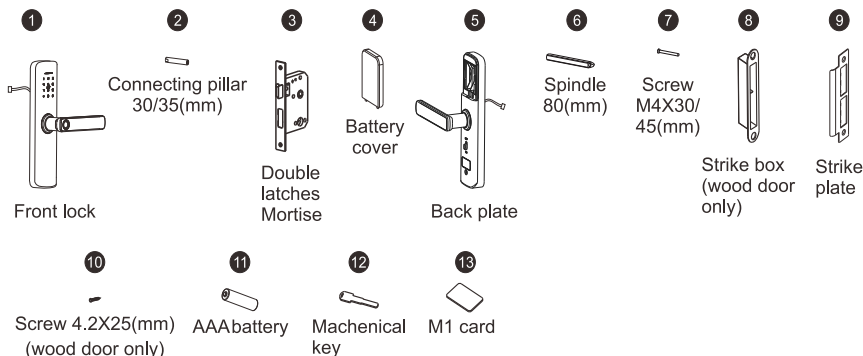

2. Door opening direction

① Right handle opening

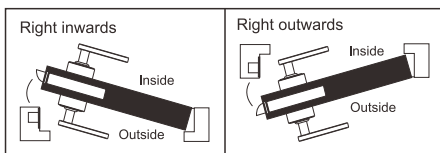

② Left handle opening

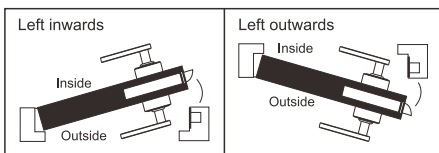

3.Shift the left and right

According to your needs to adjust the left and right by a screw driver to release screw, then turn the handle 180 degree, then fix the screw.

Note: Do not unscrew the screw in the handle hole, if there is broken when you do that, you will not have any warranty.

Front panel

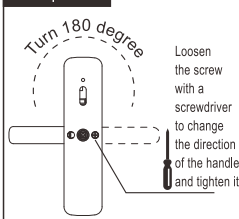

Back panel

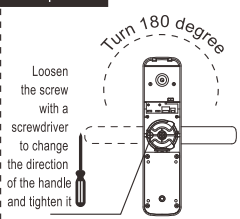

Right

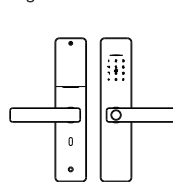

Left

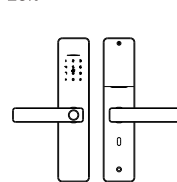

Right Opening

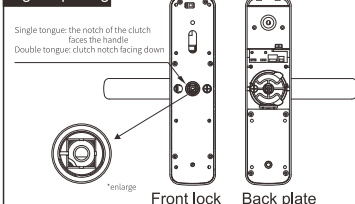

Left Opening

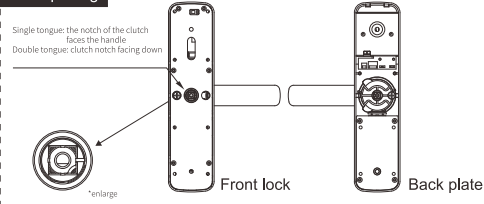

4. Adjust the mortise direction

According to the your need to adjust the mortise direction.

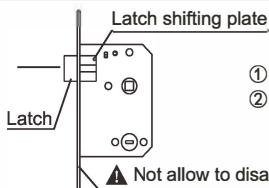

- ① Pull the Latch shifting plate to another side
- ② Push the latch into the mortise and turn 180 degree

⚠ Not allow to disassemble the face plate

5. Accessories for sorts of door thickness

Available door thickness 35mm-55mm. If the door is over this range, please contact us for more information. Please select the correct accessories according to your door thickness.

Code and name	Specifications(mm)	door thickness ranges & QTY	
		35≤M≤40(mm)	41≤M≤55(mm)
⑥ Spindle 80(mm)		1	1
⑩ Screw 4.2X25(mm) (wood door only)		4	4
⑩ Screw M4X30/ 45 (mm)		1	2
		1	
② Connecting pillar 30/35(mm)		1	2
		1	

6. Caution before installation

- ① Do not be a strong force when installation, avoid to damaging the lock.
- ② Use correct installation tools.
- ③ Wear glass to protect your eyes when drilling holes.
- ④ Drilling the door holes on both side of the door avoiding to damaging the door plate.

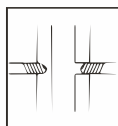
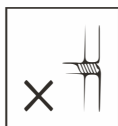
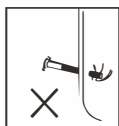

7. Installation

Installation steps:

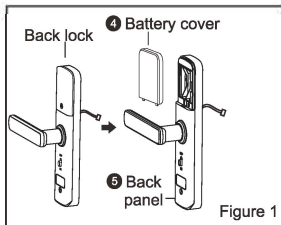

- (1) As Figure 1:
① Divide the Back Lock into Battery cover and Back panel.

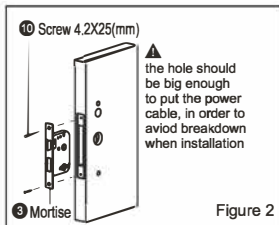

- (2) As Figure 2:
① Make the mortise cable get through the door plate, fix the mortise with 2 screws.

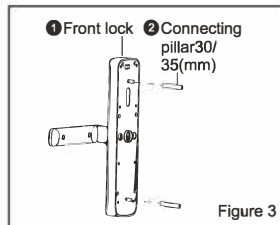

- (3) As Figure 3:
① Fix the two connecting pillars on the front panel

7. Installation

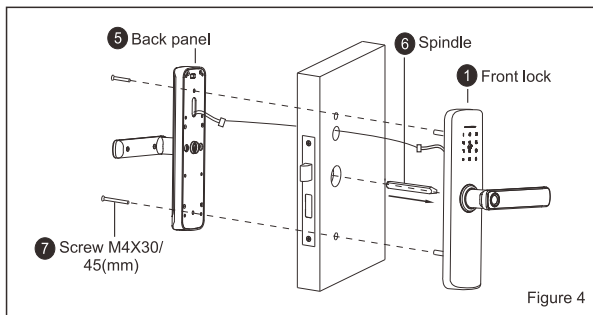

Figure 4

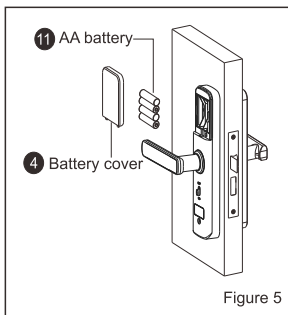

Figure 5

(4) As Figure 4:

- ① Insert the tapered end of the square shaft into the sleeve hole on the front panel.
- ② Make the front panel cable across to the door plate and connect to the back panel.
- ③ fix the front panel and back panel with two screws.

(5) As Figure 5:

- ① Put the Batteries correctly and fix the Battery cover.

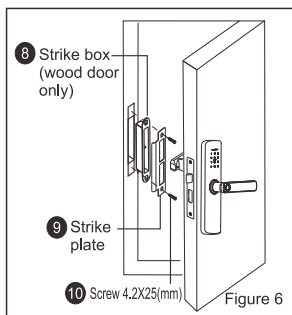

Figure 6

(6) As Figure 6:

- ① Install the strike box and strike plate on the door frame with 2 screws.
(Note: this no strike box for steel door frame)
- ② Test the lock if it works correctly.

8. Check points after installation

1. The latch panel and the door edge must be horizontal
2. All parts on the lock body can work normally and smoothly
3. The front and rear panels must be vertical and not loose
4. Pay attention to the front and rear connecting wires not to be crushed or damaged
5. Pay attention not to install the battery reversely
6. When debugging the system, the key should be worn with you to avoid being unable to enter the door

9. menu structure

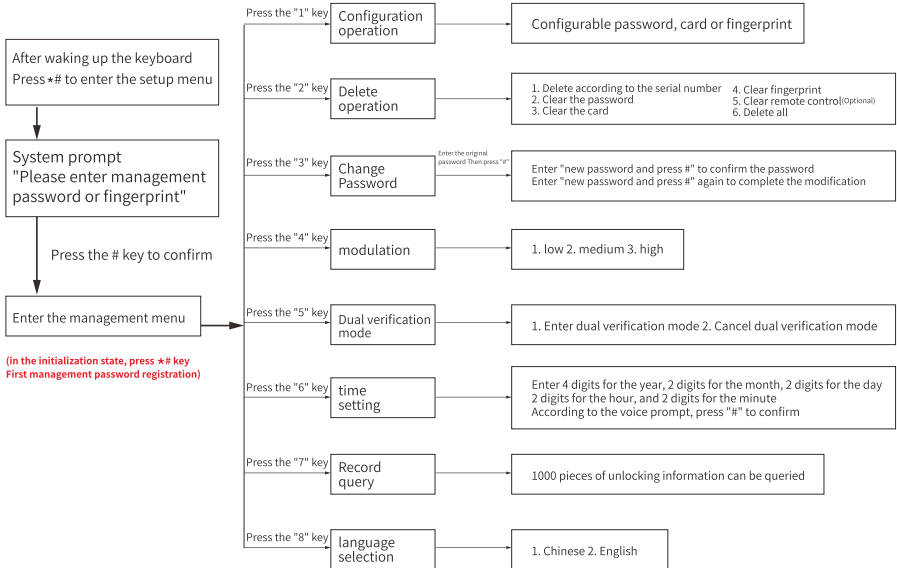

10. Configuration operation



*After entering the configuration operation, you can enter a password, card or fingerprint as needed, and the system will automatically assign the key sequence number

*The first group of keys is the management password, the system default serial number is 0, it cannot be deleted but can only be modified

*The effective number of digits is 6-10 digits

11. Delete operation



*The management password cannot be deleted, but can only be modified

12. Modify password



*Password modification is only for digital passwords, fingerprints or cards can only be deleted, and cannot be modified

13. Volume adjustment



*Volume adjustment is a three-level selection, briefly press the voice prompt to select the number corresponding to the volume and press the *#* key to confirm

14. Double authentication mode

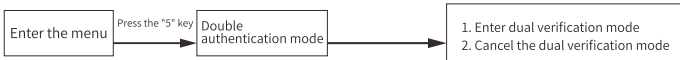

- * To open the dual authentication mode, you must pass two different key verifications to open the door.
- *The administrator unlock is not restricted by the dual authentication mode

15. Time setting

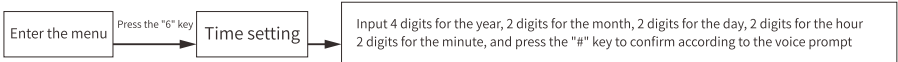

- *The time can be automatically calibrated through local modification or connecting to the server through the module

16. Unlock record



- *The "2" key is the previous one, the "8" key is the next one, and the "*" key is the return

17. Language selection



18. Quick operation

Function of "*" key: Back/Cancel/Lock with one key.

Function of "#" key: Confirm/doorbell/remote unlock request.

TUYA configuration network: After the system wakes up, enter "1, #" and verify the administrator information. After the verification is passed the mobile phone network (Tuya) operation can be performed.

Time broadcast: After the system wakes up, enter "2, #" and the system will automatically broadcast the current time of the lock.

Remote unlocking: After the system wakes up, enter "3, #" to request remote unlocking.

Mute mode: After the system wakes up, enter "4, #" to enter the silent mode, and operate it again in the same way to turn on the voice mode.

Normally open mode: After the system wakes up, enter "5, #" and then verify the administrator information. After the verification is passed it will enter the normally open mode, and it can be turned off by the same operation again.

Lock ID: After the system wakes up, enter "6, #" and then verify the administrator information, the system will automatically broadcast the ID number of the lock (for the temporary password of the mini program)

Anti-pry function operation: After the system wakes up, enter "7, #" to verify the administrator's information. After the verification is passed the pry-proof function is closed, and the same method can be opened again by operating it again.

System version number: After the system wakes up, enter "99, #" and the system will automatically broadcast the current firmware version number of the lock.

Enter the menu: After the system wakes up, enter "*"#" and then verify the administrator information and enter the menu.

Restore factory settings: Long press the reset button on the rear panel for about 6 seconds, and the system starts to initialize
(In the initialization state, any fingerprint, password, card can be unlocked)

19. Optional function (Tuya APP unlock)



TUYA APP unlock function

1. Support WeChat Mini Program
2. Mobile phone wifi unlocking function
3. Send temporary password remotely
4. APP manages door locks in real time
5. Local storage of unlocking records
6. Real-time view of unlocking records
7. APP management adds and deletes members
8. Remote authorized user unlock



Tuya distribution network: After the system wakes up, enter "1, #" and verify the administrator information. After the verification is passed, the mobile phone network distribution (Tuya) operation can be performed.

20. Optional function (remote control unlock)

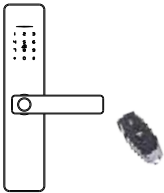

Remote unlock function

1. Code pairing method; turn on the power, short press the button once, the LED light is always on. Press any button on the remote control; the LED light flashes 3 times, code is OK.
2. Code clearing mode; power on and long press the button for 5 seconds. The LED light flashes 3 times, clearing successfully.

21. System composition block diagram

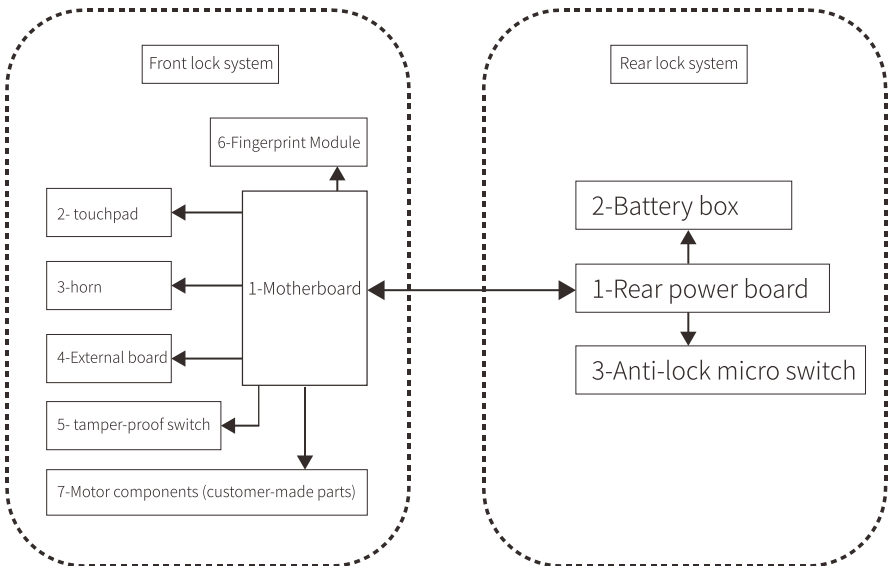

22. Function summary

1	Key management	Can save 6-10 digits password, fingerprint and card mix 299 groups 299 single password; 299 single card; 100 single fingerprint (the actual capacity depends on the fingerprint module)
2	Dynamic password management	Two functions: one-time temporary password and time period password
3	Safe mode	Support single key and double key unlocking
4	Normally open setting	After the system wakes up, enter "5, #" and verify the administrator information. After the verification is passed, it will enter the normally open mode. Operate again in the same way to close
5	system initialization	Long press the initialization button to restore the system factory settings
6	time setting	The system has time memory, which provides time basis for unlocking operation, which can be adjusted according to the current time
7	Voice prompts	Full voice navigation, simple operation
8	Attack protection	Enter the wrong key 5 times in a row, the system will automatically lock for 3 minutes, and the system will enter the locked state. Can't unlock
9	Low pressure alarm	When the battery power is low, there will be a voice prompt after unlocking: "The battery is dead"
10	Record query	Can provide the latest 1,000 unlocking operation records
11	Virtual password	Unlock password and enter 30 digits including the correct password at the end to unlock Effectively prevent others from watching and stealing passwords
12	Emergency door opening	When the battery voltage is insufficient to drive the motor, the door can be opened by an external power supply or with a mechanical key.
13	Electronic lock	After turning on the electronic anti-lock function, only the administrator can open the lock, privacy function

23. Technical parameters

CATEGORY	DETAILED TECHNICAL PARAMETERS	REMARKS
Operating Voltage	INPUT :DC4.0v~7v	Four 1.5V AAA alkaline batteries
Standby power supply voltage	USB micro interface power supply: DC 5 ~ 7V	Power supply from power bank or 5V power adapter
Suitable fingerprint sensor type	Semiconductor sensor	
password keyboard	Capacitive touch keyboard	
Number of keys	12 keys (0 ~ 9, # key to confirm, * key to cancel)	
Language method	Chinese and English voice navigation	Chinese and English phonetics
Quiescent Current	≤45uA	Under no working condition
Dynamic current	≤300mA	Power consumption when opening the door after swiping the card
Drive output	direct	Working voltage 3V ~ 6V
Driving load capacity	≤500mA	DC motor
Low voltage alarm voltage	≤4.8V (the power supply voltage is lower than the standard 80 ± 5% indicates that the battery is dead)	Comply with national standard ga374-2001 Standard of electronic anti theft lock
Card type	M1 card	
Extensible interface	Remote control module, double fingerprint module ZigBee module, graffiti module	
working temperature	-25°C~+65°C	
Record query	It can provide the latest 1000 unlocking operation records	
Number of open key	There are 299 groups of password, fingerprint and card (100 single fingerprint). Group 1 (serial number is 0) must be management password Serial numbers 1-2 are administrators and serial numbers 3 and later are ordinary users	Adopt dynamic allocation (fingerprint capacity is subject to fingerprint module)

24. Other parameters

category	Detailed technical parameters	Test Equipment
Operating temperature	-25°C~+65°C	
storage temperature	-40°C~+80°C	
Working humidity	5~95%RH (no condensation)	
Resistance to severe cold	-25°C, 0%R, the product function should be normal when placed in the freezer for 24 hours	High and low temperature laboratory
Moisture resistance	The product is put into +60°C, humidity 95%RH constant temperature humidity test box The product function should be normal after being placed for 24 hours	Constant temperature and humidity experiment box
Antistatic performance	Air discharge 15KV, contact discharge 8KV	Static tester
Number of unlocks	More than 1 million times	Aging frame
Anti-battery interference performance	1. The Tesla coil should not be able to be unlocked if it interferes with all parts and surfaces of the entire lock 2. Use high-power radios and walkie-talkies to interfere with all parts and surfaces of the entire lock. The lock should not be unlocked.	Tesla coil High-power radio Walkie talkie

Warranty Card

1. The factory packaging of the product is equipped with this manual and warranty card. After the user has installed it, please fill in the content of the warranty card and keep it properly as a warranty certificate.
2. This product is fully covered within one year
3. The following are not covered by the warranty:
 - A. Damage caused by accidental factors or human actions and external forces (including violent prying, inputting unsuitable voltage, etc.)
 - B. Causes of force majeure such as natural disasters (such as earthquakes, floods, fires, etc.)
4. For warranty coverage, we will charge corresponding fees.
5. When the product fails, please ask the local dealer for repair, and write down the specific address, name, phone number and failure phenomenon

Commodity	Product name	
	Product model	
	Purchase price	
	Purchase date	
user	User name	
	contact number	
	Contact address	
	Postal Code	
Sales	Name of seller	
	Seller's address	
	contact number	
	Invoice number	
	Seal of seller	

Maintenance record (to be filled in by maintenance organization)

Maintenance date	Fault condition	Maintenance record	Authorized maintenance seal