

Scandinavian Electronic Lock

EXLH-S020

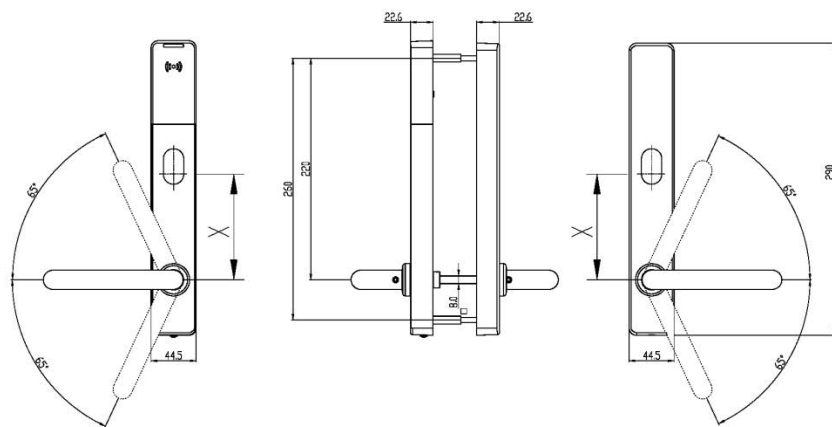

SCANDINAVIAN ELECTRONIC LOCK FOR OFFICE

The narrow electric handle EXLH-S020 in Scandinavian style is an elegant and functional solution dedicated to office doors. Managed via the Evokey app, available for Android and iOS systems, it allows for opening doors with a smartphone, adding Mifare 13.56 MHz cards and key fobs, viewing event history, and monitoring battery charge level. This is a modern combination of style, convenience, and advanced technology.

TECHNICAL DATA

Model	EXLH-S020
Management	Evokey application (phone), offline from the computer
Event memory	Yes (last 500 events)
Power supply	3 x AAA battery
Thickness of the door	35 - 120 mm
Access	Bluetooth BLE application (iOS & Android), Mifare card 13.56 MHz, mechanical key
Dimensions	290 mm x 44 mm x 22.6 mm
Application	For indoor use
Recommendations	It is not recommended to install the handle in high traffic areas (up to 30 passages per day)
Warranty	2 years